

# CALIFORNIA NATIVES

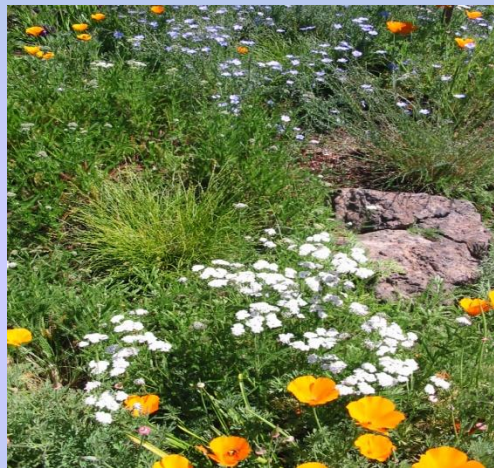

# IN YOUR GARDEN

Deva Luna

408-871-2792

EarthCare Landscaping

# WHY NATIVES?

- California has a very unique flora
- Plants and pollinators interdependent
- Developed in our unique climate-  
cool, rainy winters & dry warm summers
- Ecological-use less chemicals
- Economical-use less water
- Smart gardening-use less labor

# SANTA MONICA DEMONSTRATION



Conventional Landscaping

"California Natives"



# CONVENTIONAL GARDEN FIVE MONTHS LATER





# CALIFORNIA NATIVE GARDEN FIVE MONTHS LATER



# California Style compared to Conventional:

- 1/4 of the maintenance labor
- 3/5 of the green waste
- 1/10 of the water

To view online:

[santa-monica.org/epd/news/gardengarden.htm](http://santa-monica.org/epd/news/gardengarden.htm)

# Annual Comparison

## Sustainable Landscape



6,000 Gallons

WATER



250 Pounds

YARD WASTE



15 Hours

MAINTENANCE

## Traditional Landscape



57,000 Gallons

WATER



670 Pounds

YARD WASTE



80 Hours

MAINTENANCE

garden/garden in Santa Monica





Photo and Design: Stephanie Morris





Photo & Design: Pete Veilleux, East Bay Wilds





Design: Stephanie Morris, Installation: EarthCare Landscaping





Design: Sherri Osaka , Installation: EarthCare Landscaping





Photo: Deva Luna





Photo: Laura Gardener





Design: Annaloy Nickum Photo: Deva Luna



# Habitat Gardens!



**Pipevine (Aristolochia) &  
Pipevine Swallowtail**





Monarch caterpillar on Showy Milkweed





Just add water to attract birds!



# “LAWN” SUBSTITUTES



**Herbs, Groundcovers, Meadows**





Design: Cheryl Renshaw

# MIXED HERB LAWN





Design & Photo: Stephanie Morris

# YARROW LAWN





Photo: Stephanie Morris



# ECO-LAWN



# “NO MOW” GRASSES

- Seasonal changes
- Flowers sway in the breeze
- Can be mowed as a traditional lawn or yearly
- Can be weed whacked annually
- Provide habitat for birds, butterflies
- Can be interplanted with wildflowers



# RED FESCUE





**String trimming to renew meadow**

# Spreading Grasses

- Red Fescue *Festuca rubra*
- Dune Sedge *Carex pansa*
- CA Field Sedge *Carex praegracilis*
- Idaho Fescue *Festuca idahoensis*

# Bunching Grasses

- Foothill Sedge *Carex tumulicola*
- California Fescue *Festuca californica*
- June Grass *Koeleria macrantha*
- Purple Needle Grass *Nasella pulchra*
- Leafy Reed Grass *Calamogrostis foliosa*
- Blue Grama *Bouteloua gracilis*
- Thin Grass *Agrostis pallens*





**NATIVE SOD NOW AVAILABLE**





Design: Middlebrook Gardens Photo: Stephanie Morris

# FESTUCA OCCIDENTALIS

## Western Fescue





Design: Erin Dougherty Photo: Deva Luna

# **BERKELEY SEDGE**

**Carex tumulicola (C. divulsa)**





Design: Erin Dougherty

Photo: Laura Gardener

# Berkeley Sedge after haircut





# CAREX PANSA

Design: Agi Kehoe

Installation: EarthCare Landscaping



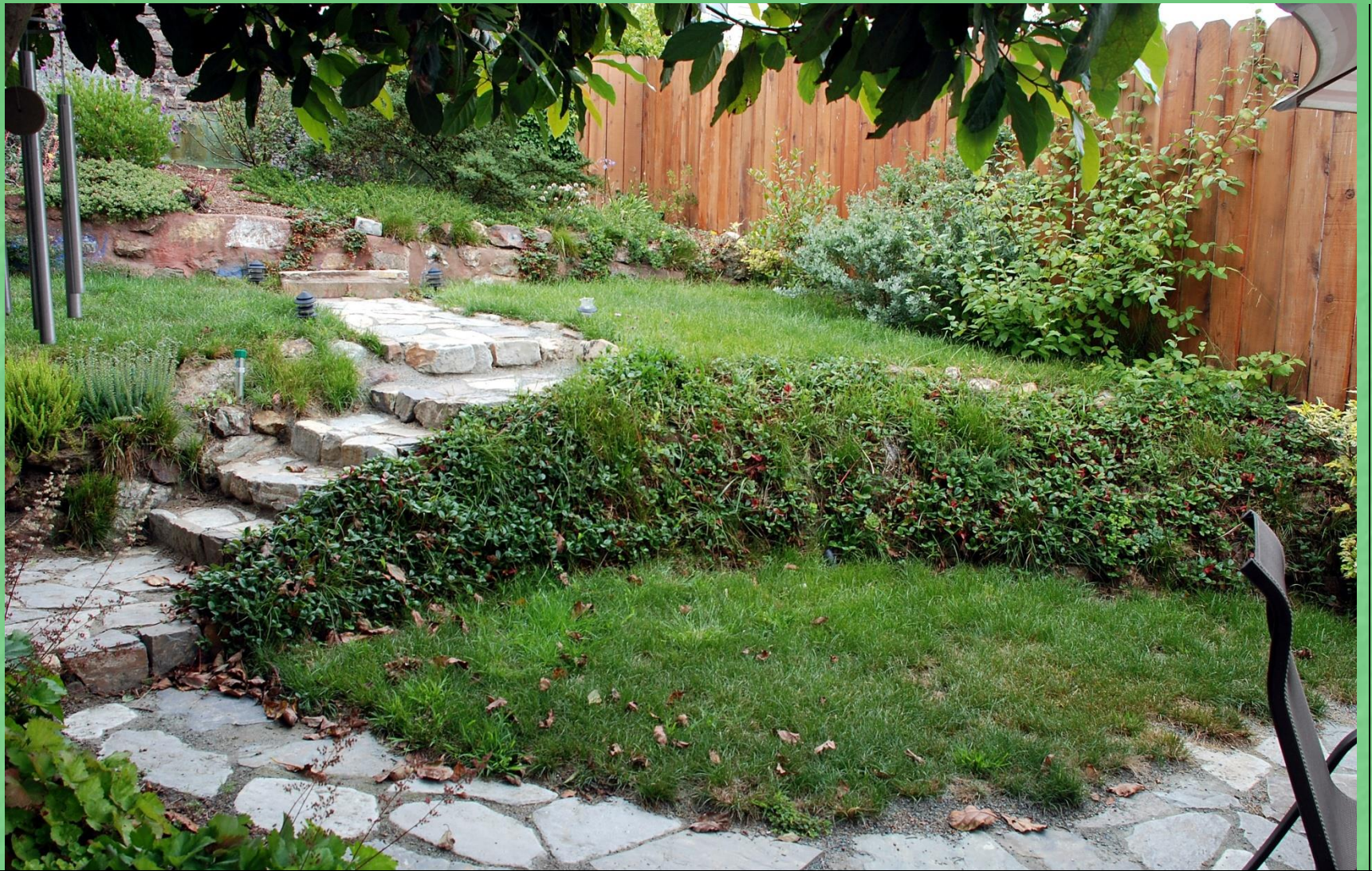

**Carex pansa mowed as lawn**

Photo & Design by Pete Veilleux





Design & Photo: Agi Kehoe

# Berkeley Sedge with wildflowers





Design: Agi Kehoe Photo: Deva Luna

# Wildflowers in a meadow





# Chaparral, Grassland, and Desert Plants



**Sun, dry or occasional deep watering**







**Arctostaphylos 'Dr. Hurd'**  
**Manzanita**





# Salvia 'Bee's Bliss'

Design: Stephanie Morris

Installation: Curtis Horticulture





**Baccharis pillularis 'Twin Peaks'**  
**Dwarf Coyote Bush**





**Dendromecon harfordii**  
**Island Bush Poppy**





**Matilija Poppy**  
***Romneya coulteri***





**Woolly Blue Curls**  
***Trichostema lanatum***



# California Fuchsia *Epilobium* 'Calistoga'







**Ceanothus 'Concha'**





**Rosy Buckwheat**  
***Eriogonum grande* var. *rubescens***







**Foothill  
Penstemon**





**Deer Grass *Muhlenbergia rigens***





**COYOTE MINT**  
***Monarda villosa***





***Artemesia pynocephylla* 'David's Choice'  
Sandhill Sagebrush**





**Monkey Flower**  
***Mimulus aurantiacus* 'Valentine'**







# Yarrow

*Achillea millefolium* 'Pink Island Form'





# Riparian and Coastal Plants



**Part sun, watered regularly  
Afternoon shade, moderate water**







**Idaho Fescue**  
***Festuca idahoensis***



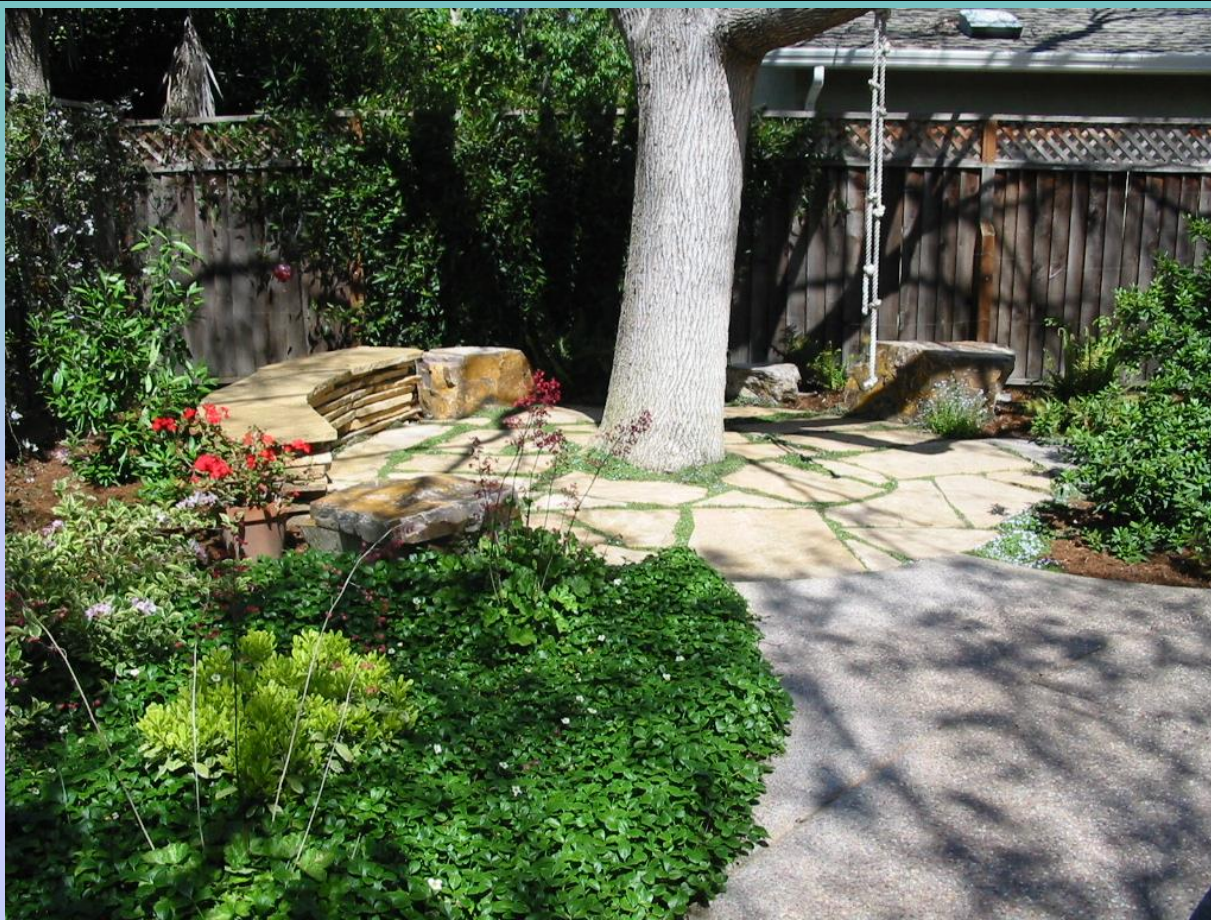

Design: Sherri Osaka Photo: Deva Luna

# **Fragaria chiloensis – Beach Strawberry**





**Vine Maple**  
***Acer circinatum***





Design & Photo: Sherri Osaka

# Ceanothus hearstiorum

## California Lilac





**Cedros Island Verbena**  
**Verbena lilacina 'De La Mina'**





Photo: Deva Luna

# Beach Aster

*Erigeron glaucus* 'Wayne Roderick'





# Oak Woodland



**Shade or part shade, dry or  
occasional deep watering**

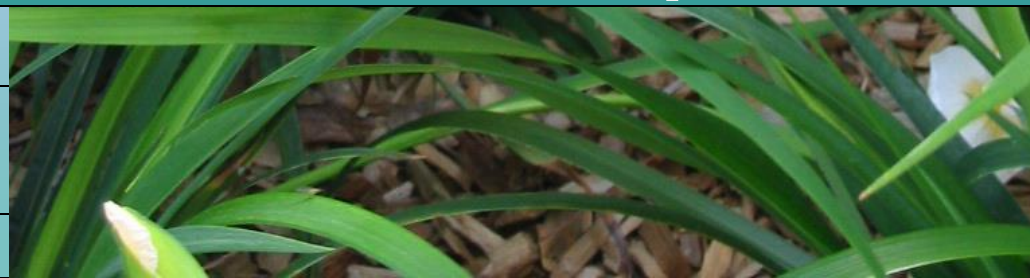





**Pacific Coast Hybrid Iris**





Design: Fran Adams Photo: Deva Luna

# Heuchera 'Old La Rochette - Alum Root



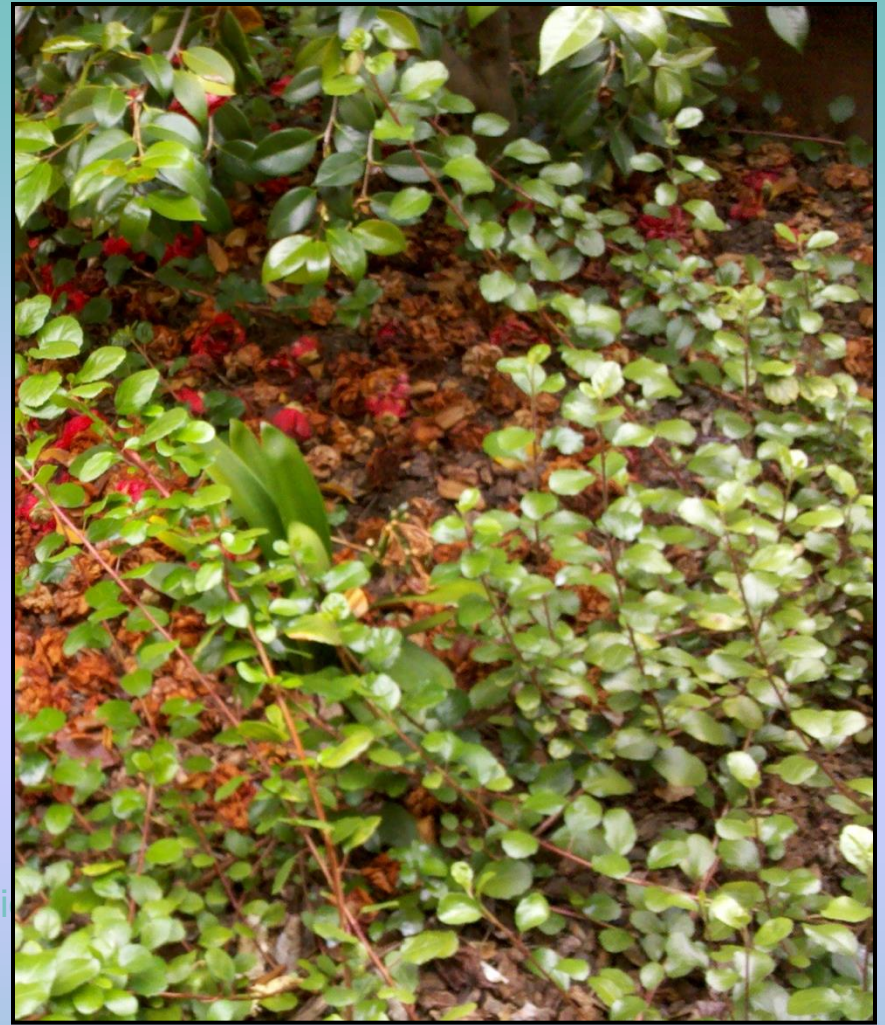
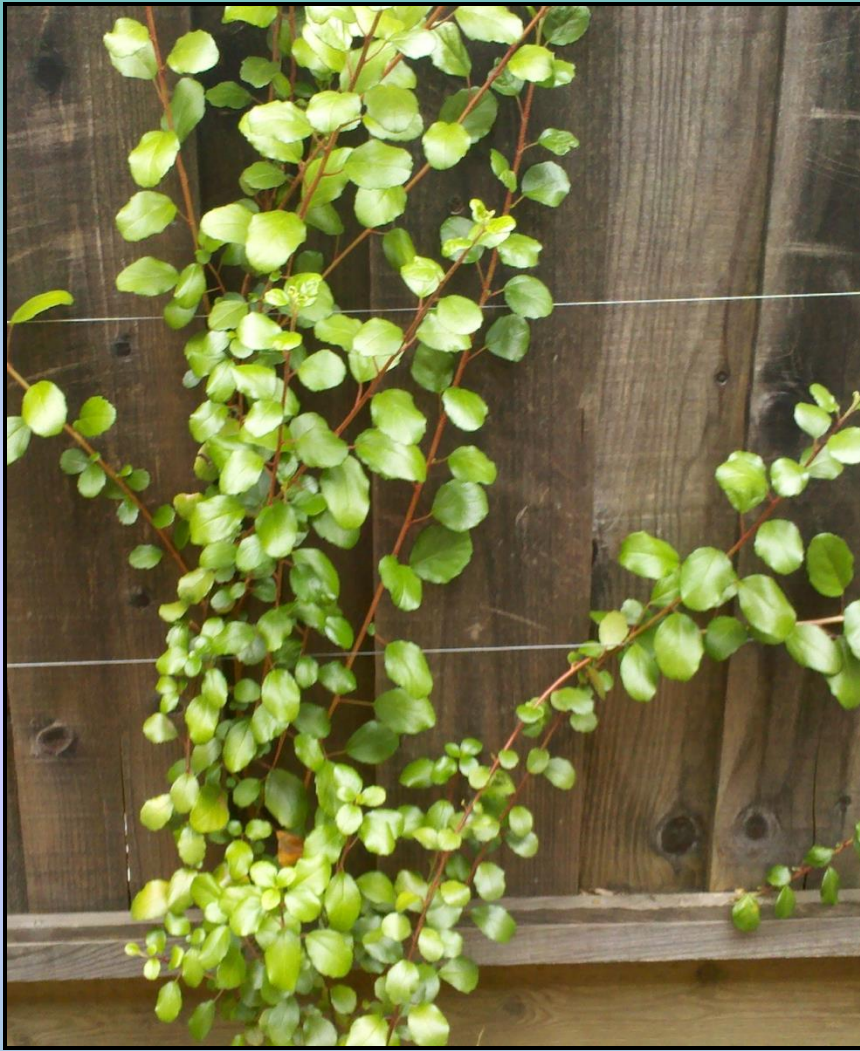

Desi

**Ribes viburnifolium – Evergreen Currant**





**Hummingbird Sage**  
***Salvia spathacea***





**California Coffeeberry**  
***Rhamnus californica* 'Eve Case'**







**Toyon**  
***Heteromeles arbutifolia***







**California Grape**  
***Vitis californica* 'Roger's Red'**



# Redwood Forest



**Shade, watered regularly**





**Wild Ginger**  
***Asarum caudatum***





**Western Bleeding Heart**  
***Dicentra formosa***





**Western Columbine**  
***Aquilegia formosa***





**Flowering Currant**  
***Ribes sanguineum***





**Western Azalea**  
**Rhododendron occidentale**





**Western Sword Fern**  
***Polystichum munitum***





**Wax Myrtle**  
***Myrica californica***



California natives can be spectacular!!!

